

## Standalone Access Control

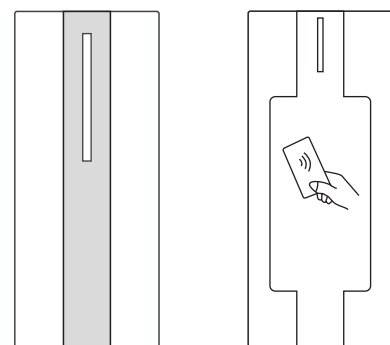

Type A

Type B

### User Manual

Please read the user manual carefully before installation.

### INTRODUCTION

The two series products are contact less proximity card Standalone Access Control, programmed by infrared remote control. Material of the housing for Type A is ABS plastic, and Zinc-alloy for Type B. Anti-vandal design, and equipped with Admin cards.

### Features and Benefits

- > Waterproof, conforms to IP67
- > Can add proximity cards sequentially numbered
- > Pulse Mode, Toggle Mode
- > User capacity: 2000
- > Anti-vandal design
- > Admin can add/delete admin cards

### Specifications

Operating Voltage	10-24V DC
Working Current	≤80mA
Weatherproof	IP67
Read Range	≤8cm
User Capacity	2000
Card type	EM Card
Card Frequency	125KHz
Lock Output Load	≤2A
Operating Temperature	-40°C ~ +70°C, (-40°F ~ 158°F)
Operating Humidity	10% ~ 98%RH
Dimensions	L100xW43xH20mm
Unit Weight	Type A: 110g, Type B: 220g
Shipping Weight	Type A: 180g, Type B: 290g

01

### Packing List

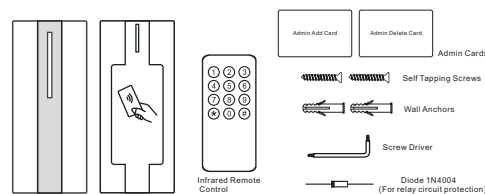

### INSTALLATION

- > Remove the back cover from the unit with screw.
- > Drill hole on the wall according to the back size of the machine or install distributing box well.
- > Thread the cable through cable hole, connect related cable. For the un-used cable please separate with insulating tape.
- > After wiring, install front casing to the back casing and fix well.

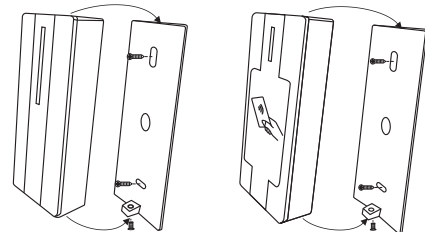

02

### Wiring

Wire Color	Function	Notes
Green	NC	Relay NC
Brown	COM	Relay COM
White	NO	Relay NO
Black	GND	Negative Pole
Red	DC+	10-24V DC Power Input
Yellow	OPEN	Connect to Exit button and the Exit button is connected to GND

### Sound and Light Indication

Operation Status	LED	Buzzer
Stand by	Red light bright	--
Enter programming mode	Red light shines	--
In the programming mode	Orange light bright	--
Open lock	Green light bright	One beep
Operation failed	--	3 beeps

### Factory Default settings and add admin cards

Power off, press and hold exit button, power on, release it until hear two beeps. Read two cards, the first card is "Admin Add Card", and the second card is "Admin Delete Card", then the device will be in standby mode, resets to factory default setting and adding admin cards are successful.

If you don't need to add admin cards: Power off, press exit button, power on, release it until hear two beeps, and the orange LED turn on. Waiting for ten seconds, there is a beep and it will be in standby mode, resets to factory default setting is successful.

Reset to factory default, the users' information is still retained.

03

### STANDALONE MODE

#### Connection Diagram

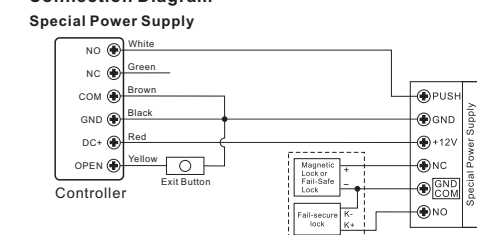

#### Universal power supply

**Attention:** Install a 1N4004 or equivalent diode is needed when use a common power supply, or the reader might be damaged. (1N4004 is included in the packing).

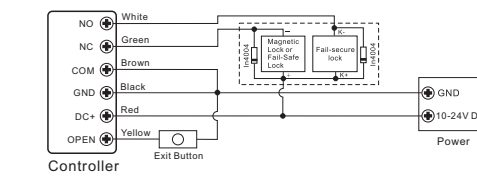

04

Quick Start and Operation	
<b>Quick Settings</b>	
Enter the Programming Mode	* - Admin Code - # Then you can do the programming (Factory default is 777777)
Change the Admin Code	0 - New Code - # - Repeat the New Code - # (New Code: any 6 digits)
Add Card User	1 - Read Card - # (Cards can be added in continuously)
Delete User	2 - Read Card - # (for Card User) 2 - User ID - # (for PIN User)
Exit from the Programming Mode	*
<b>How to release the door</b>	
Open door by card	(Read Card)

05

### Add/Delete Users by Admin Card

Using Admin card to add/delete card users	
Add users	Step 1: Read Admin Add Card Step 2: Read user cards (Repeat step 2 for additional user cards) Step 3: Read Admin Add Card again to end
Delete users	Step 1: Read Admin Delete Card) Step 2: Read user cards (Repeat step 2 for additional user cards) Step 3: Read Admin Delete Card again to end

### Enter and Exit Program mode

Programming Step	Keystroke Combination
Enter Program Mode	* (Admin Code) # (Factory default is 777777)
Exit Program Mode	*

For safety, the Admin must change the Admin code.

### Modify Admin Code

Programming Step	Keystroke Combination	LED
Enter Program Mode	* (Admin Code) #	Red shines
Update Admin Code	0 (New Admin Code) # (Repeat New Admin Code) # (Admin Code is any 6 digits)	Orange bright
Exit Program Mode	*	Red bright

For security, you must change the Admin Code and then keep in mind.

### Add users by Infrared Remote Control (ID number: 1-2000)

Programming Step	Keystroke Combination	LED
Enter Program Mode	* (Admin Code) #	Red shines
Add User: by Card	1 (Read Card) #	Orange bright
Add User: by ID number	1 (Input ID number) # (Read Card) #	
Add Cards with sequentially numbered	8 (ID number) # (8/10 digits card number) # (The number of cards) #	Red bright
Exit Program Mode	*	

#### Note:

- When swiping cards to add users, ID number will be from small to big, ranged from 1 - 2000.
- Before add the cards sequentially numbered, the ID number should be sequential and empty.

### Delete Users by Infrared Remote Control

Programming Step	Keystroke Combination	LED
Enter Program Mode	* (Admin Code) #	Red shines
Delete User - By Card	2 (Read Card) #	Orange bright
Delete User - By ID number	2 (Input ID number) #	
Delete All User	2 0000 #	Orange bright
Exit Program Mode	*	Red bright

06

### Pulse Mode and Toggle Mode Setting

Programming Step	Keystroke Combination	LED
Enter Program Mode	* (Admin Code) #	Red shines
Pulse Mode	3 (1-99) #	Orange bright
Toggle Mode	3 0 #	Orange bright
Exit Program Mode	*	Red bright

#### Note:

- Factory default is **Pulse Mode** and the access time is 5 seconds. When set the access time to "0", the device will be in Toggle Mode.
- Pulse Mode:** The door will be closed automatically after opening the door for a while.
- Toggle Mode:** Under this mode, after opening the door, the door won't be closed automatically until next valid user input. That is to say, whether open or close the door, you must swipe valid card.

### Alarm Output Time Setting

Programming Step	Keystroke Combination	LED
Enter Program Mode	* (Admin Code) #	Red shines
Set alarm time	6(1-3) #	Orange bright
Exit Program Mode	*	Red bright

#### Note:

- Factory default is 1 minute.
- Alarm time includes: the alarm time of anti-vandal, safe mode and closing reminder time.
- Swipe valid card can remove the alarm.

07

### Set Safe Mode

Programming Step	Keystroke Combination	LED
Enter Program Mode	* (Admin Code) #	Red shines
Normal Mode	7 0 # (Factory default)	Orange bright
Lockout Mode	7 1 #	Orange bright
Alarm output Mode	7 2 #	Orange bright
Exit Program Mode	*	Red bright

#### Note:

- Lockout Mode:** If swipe card/input PIN with invalid users for 10 times in 1 minute, the device will be lockout for 10 minutes. When the device repowered, the lockout will be canceled.
- Alarm Output Mode:** If swipe card/input PIN with invalid users for 10 times in 1 minute, the buzzer built-in will be activated.

### Users Setting

How to release the door	
Open door by card	(Read Card)

08